

## Patterson Civic Center Classroom Seating with Vendor Fair

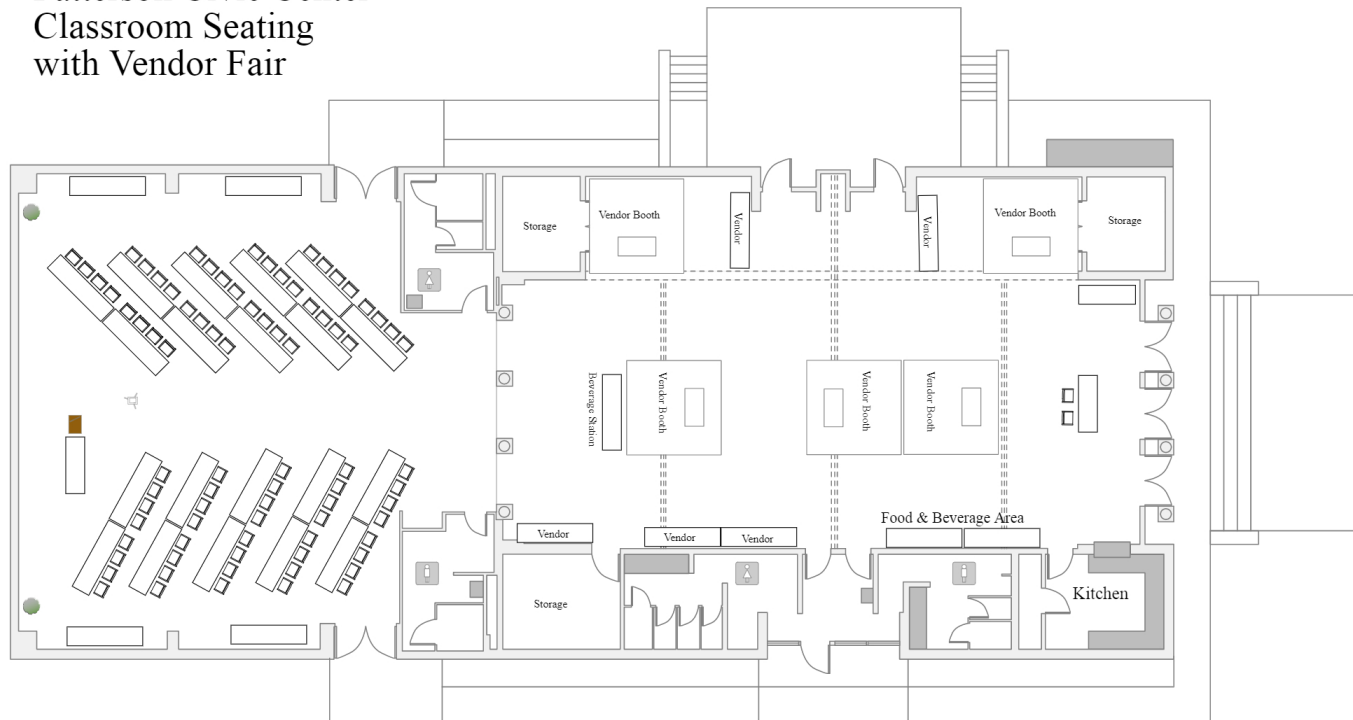

The Patterson Civic Center is approximately 52ft x 122ft for approximately 6200 sqft. The attached floorplan is a sample layout of seating arrangements for Patterson Center which will seat 80 people Classroom Style in the Auditorium, with Vendor Booths & Tables in the Hall. The Center can accommodate more people than this sample layout. According to the 1997 Standard Building Code, the square foot assembly space could support 600 people maximum. However, from a practical standpoint, this number should be 450 maximum. Table seating with maneuverable space would decrease this count.